

LOCATION PLAN OF PROPOSED G+III STORIED RESIDENTIAL BUILDING U/S 393 A OF KMC ACT 1980 ALONG WITH K.M.C. BUILDING RULES 2009 AT PREMISES NO.- 143, BHUBAN MOHAN ROY ROAD, WARD NO. 123, BR. XVI, UNDER K.M.C.

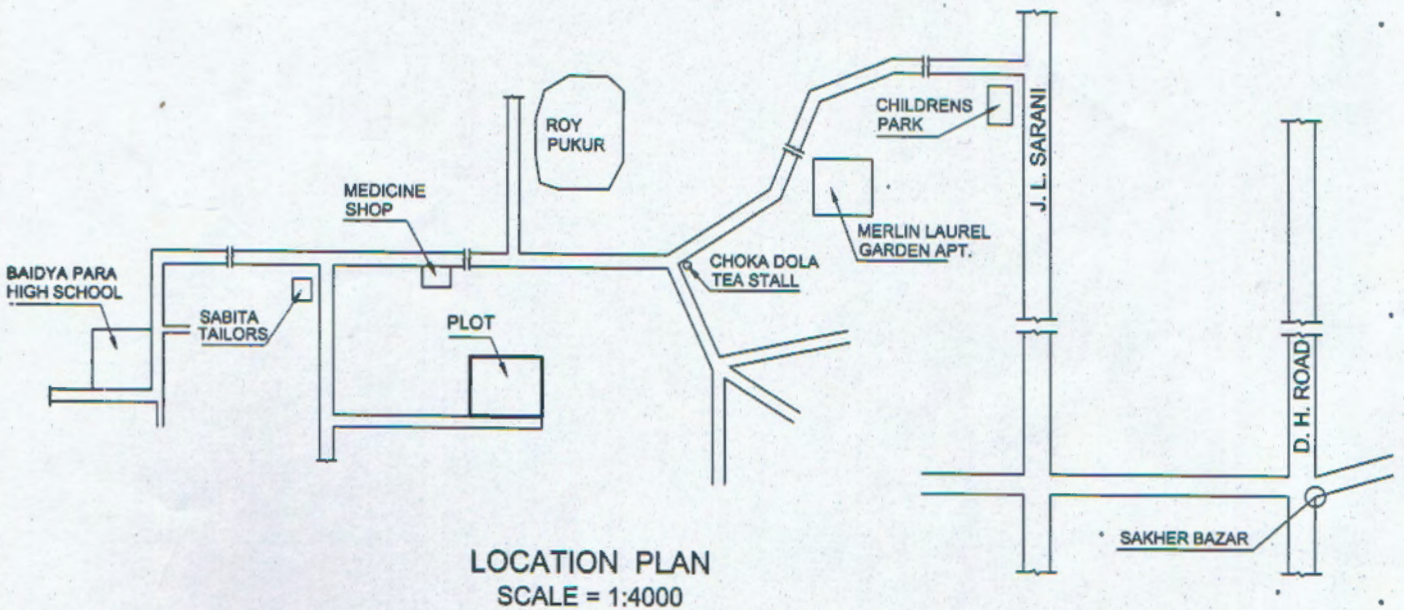
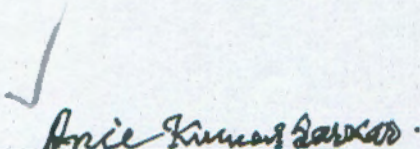

LOCATION PLAN  
SCALE = 1:4000

  
SIGN. OF OWNER

  
MALA MUKHERJEE  
COUNCIL OF ARCHITECTURE  
REGN. NO. : CA/2016/76768  
SIGN. OF ARCHITECT